

Scope of Supply/Bill of Material & Mounting Drawings

Part Number: T-T900-17-01-SL / T-T900-17-02
 Part Description: Crash bar Triumph Tiger900
 Applicable to both Stainless Steel Versions

Installation / Parts List / Bill of Material for Mounting

NO.	Description	Quantity	Torque * (N-M)	Remarks **
1	Crash Bar Lower LH	1		
2	Crash Bar Top LH	1		
3	Crash Bar Top RH	1		
4	Crash Bar Lower RH	1		
5	Bracket RH	1		
6	Bracket LH	1		
7	Bush RH	1		
8	Bush LH	1		
9	Top Bracket	1		
10	Pin pipe upper	2		
11	Pin pipe	1		
12	Slider Guards	2		
13	Socket head cap Screw M10x1.25 L60	2	44-48	Use Liquid Thread Locker
14	Socket head cap Screw M10x1.25 L95	1	44-48	Use Liquid Thread Locker
15	Socket head cap Screw M10x1.25 L135	1	44-48	Use Liquid Thread Locker
16	Socket head cap Screw M8x15	5	22-24	Use Liquid Thread Locker
17	Socket head cap Screw M8x25	1	44-48	Use Liquid Thread Locker
18	Socket head cap Screw M8x60	2	22-24	Use Liquid Thread Locker
19	Socket head cap Screw M10x35	2	44-48	Use Liquid Thread Locker
20	Socket button head Screw M6x15	6	9-10	Use Liquid Thread Locker
21	Nut M8	2		
22	Washer M6	6		
23	Washer M8	8		
24	Washer M10	2		
SRC Design uses Metric System of Measurement and all dimensions in Millimeters				
* Recommended to use the Torque specified in the table				
** Denotes Usage of Liquid Thread Locker in specified Locations				

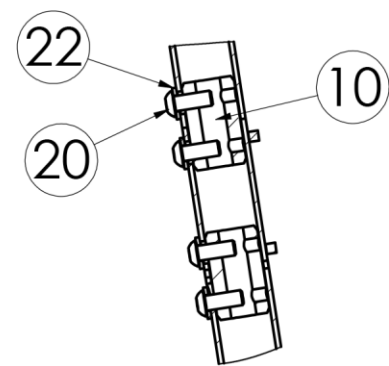
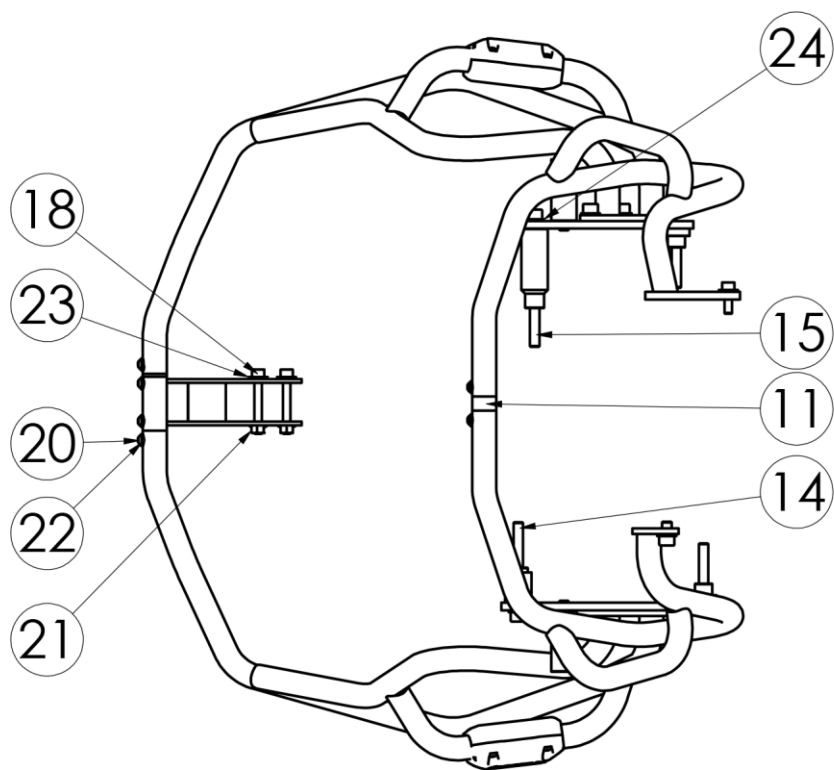
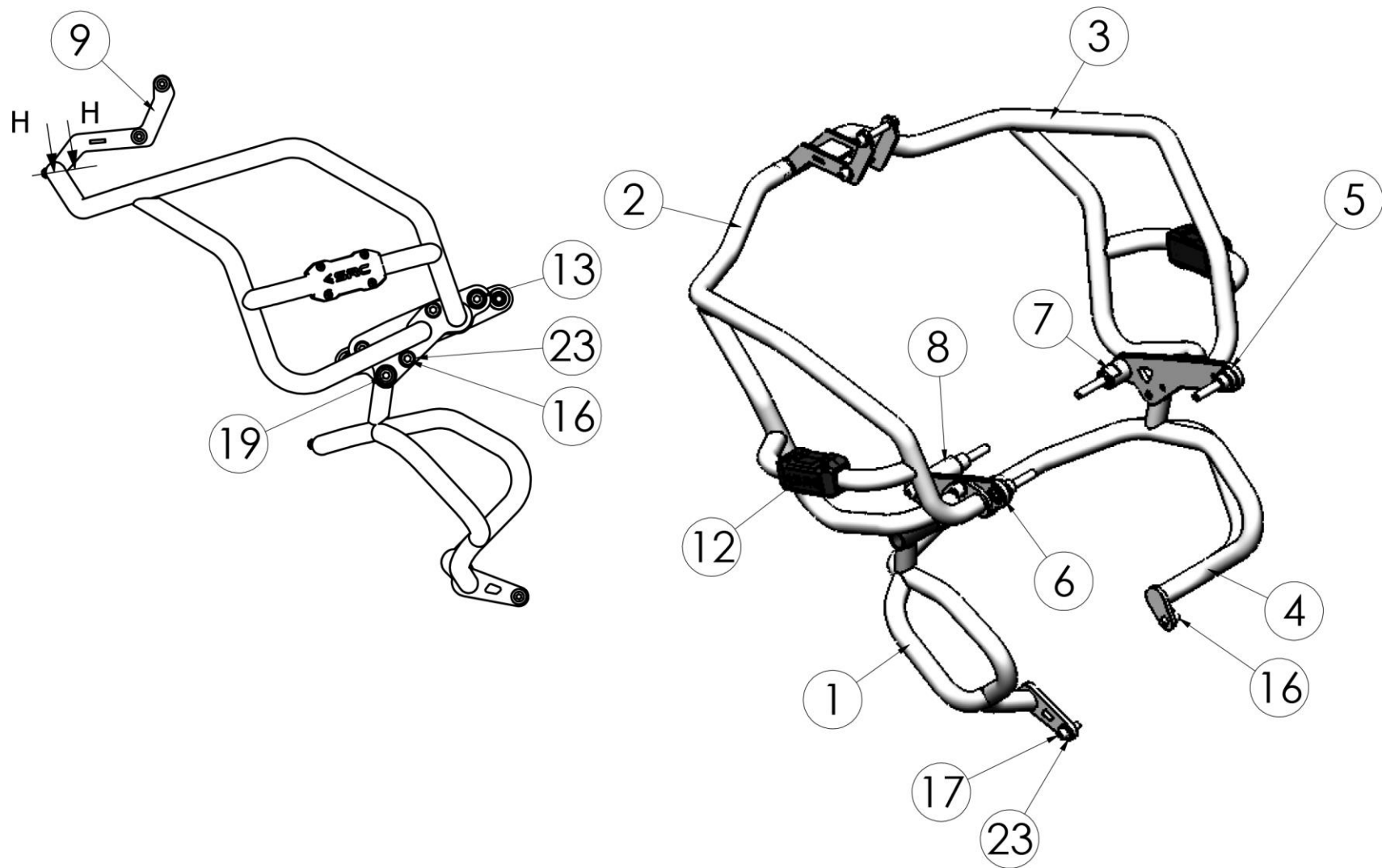

SECTION H-H
SCALE 1 : 3

Before starting to mount the Top Bracket

The Original Hole for mounting the Top Bracket can be found in-between the front forks and positioned inside

And move the original screw in motorbike (as show)

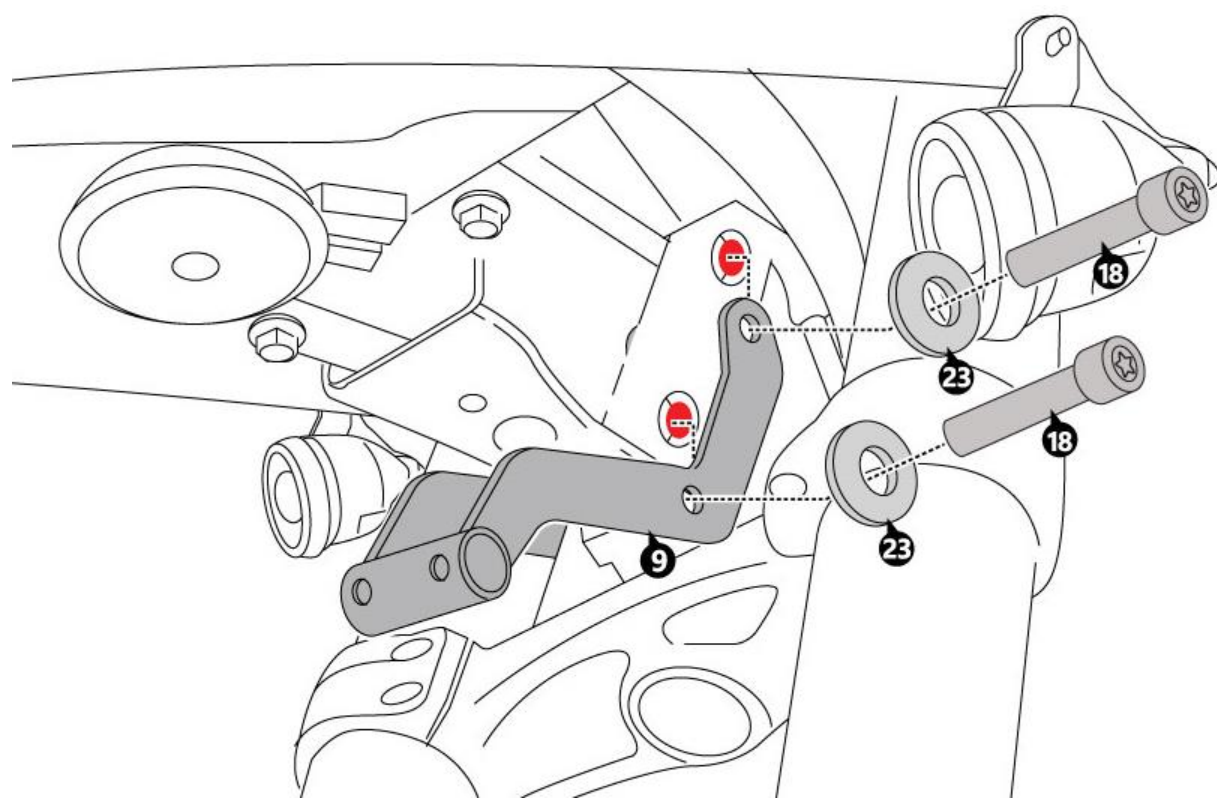
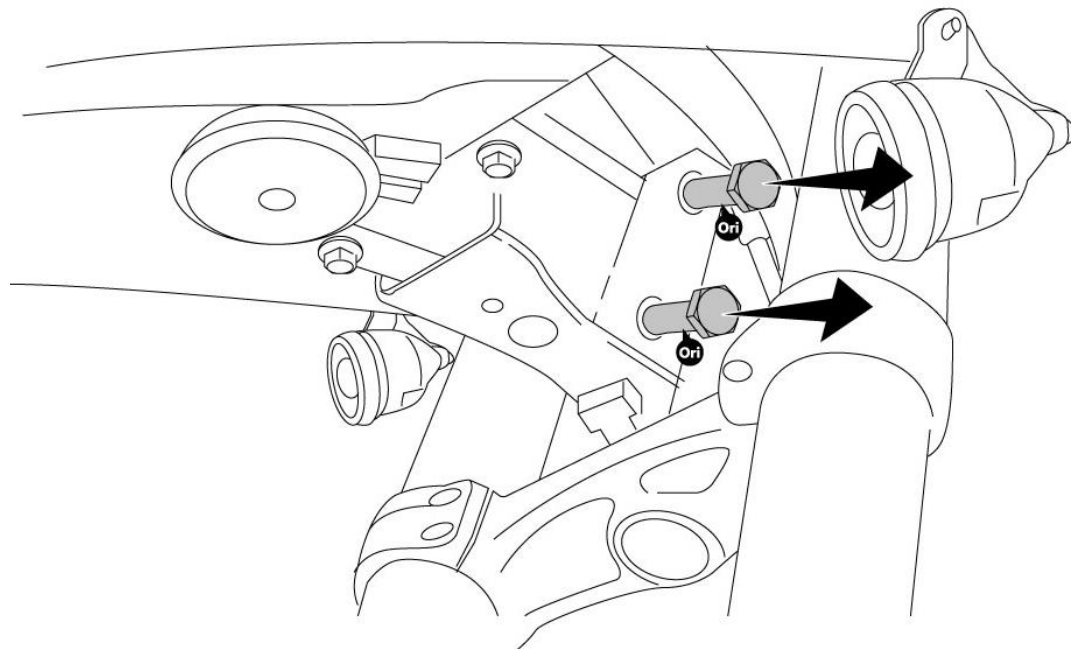

Step 1:

Orient, Mount and Fit the Top Bracket (9) to the Motorbike Chassis frame (as show)

Use M8 x 60 Screw (18) – 2 off and Washer M8 (23) – 2 off, as shown in the BOM table and the drawing.

Do not tighten the screws fully.

Step 2:

Use the Nut (21) - 2 off as shown in the BOM table and the drawing.

Do not tighten the screws fully.

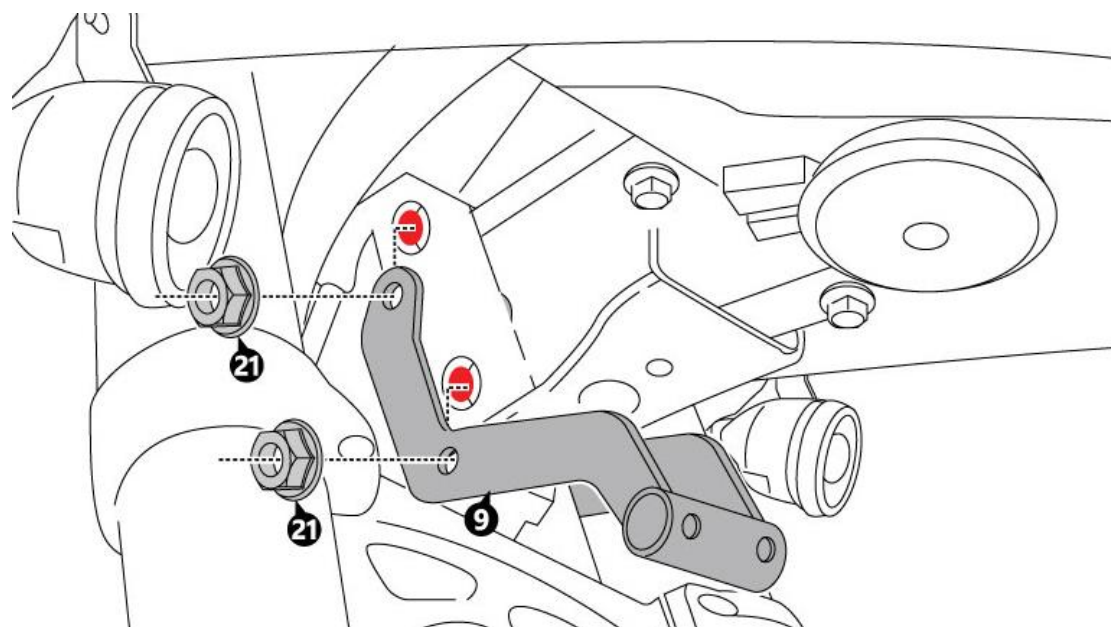

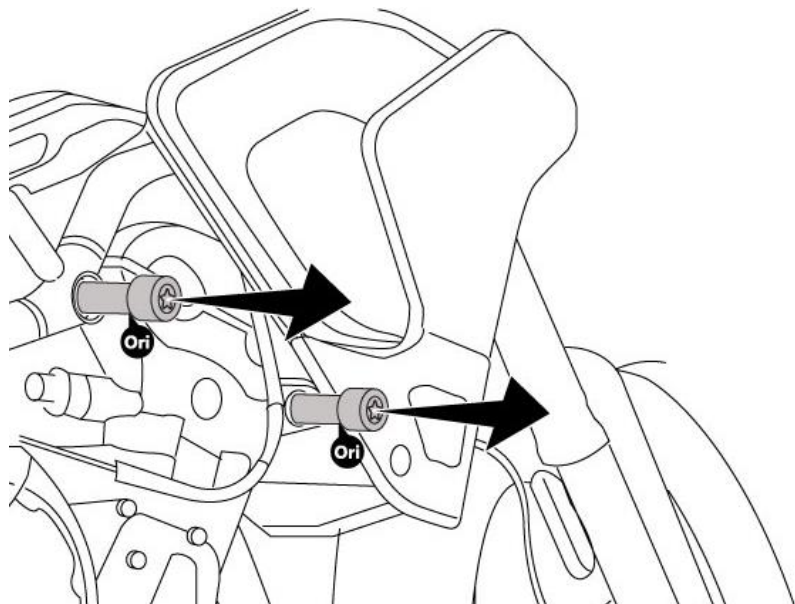

Step 3:

Before starting to mount the Bracket we have to unscrew the Mounting - 2 Original Screw in Motorbike. (As shown)

Step 4:

Orient the Bracket RH (5) is to be mounted to the Motorbike Chassis Frame as shown. Slide-in the Bush (7) -1 off, Washer (24) -1 off, Screw M10 x 95 (14) -1 off, Screw M10x60 (13) and through the Mounting hole in the Bracket RH (6) and secure the threads in the Motorbike. (As shown)

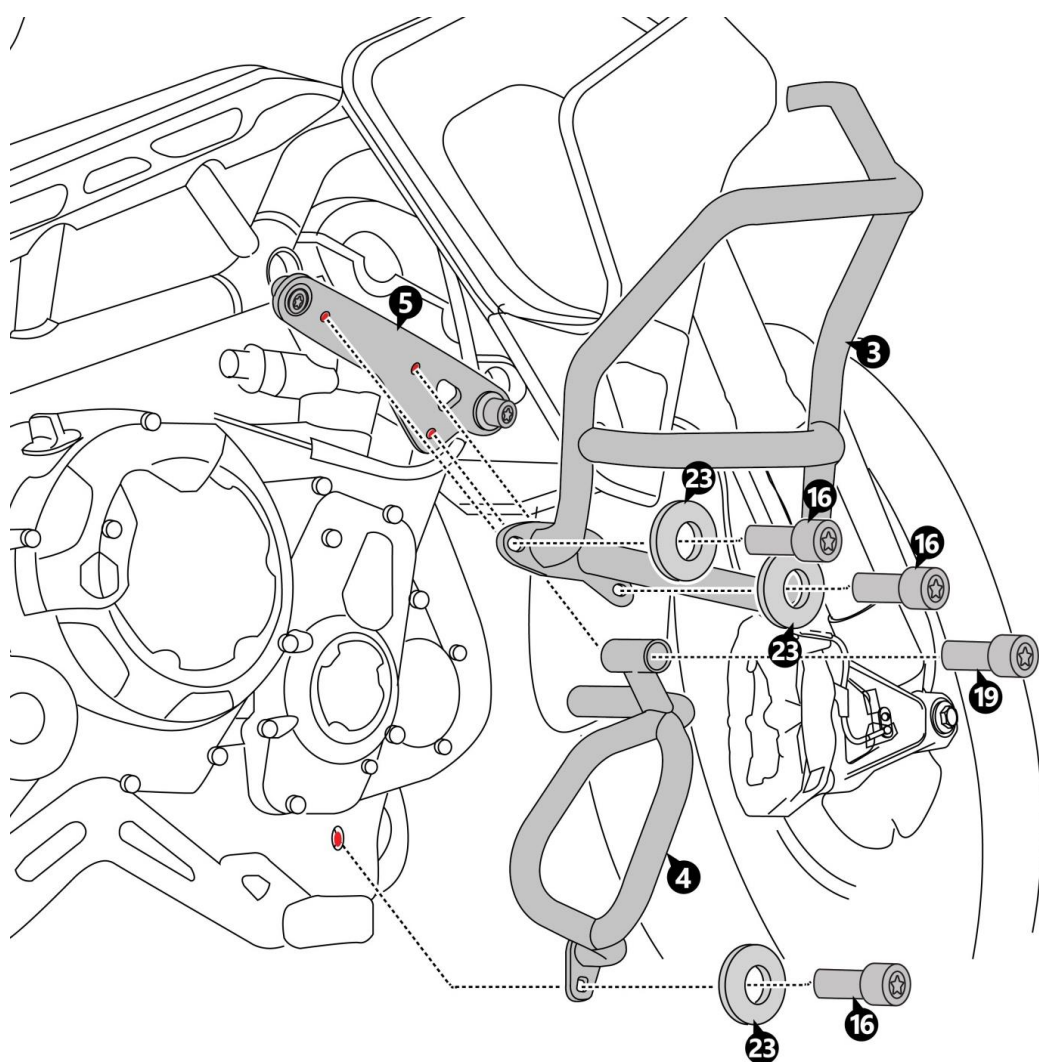
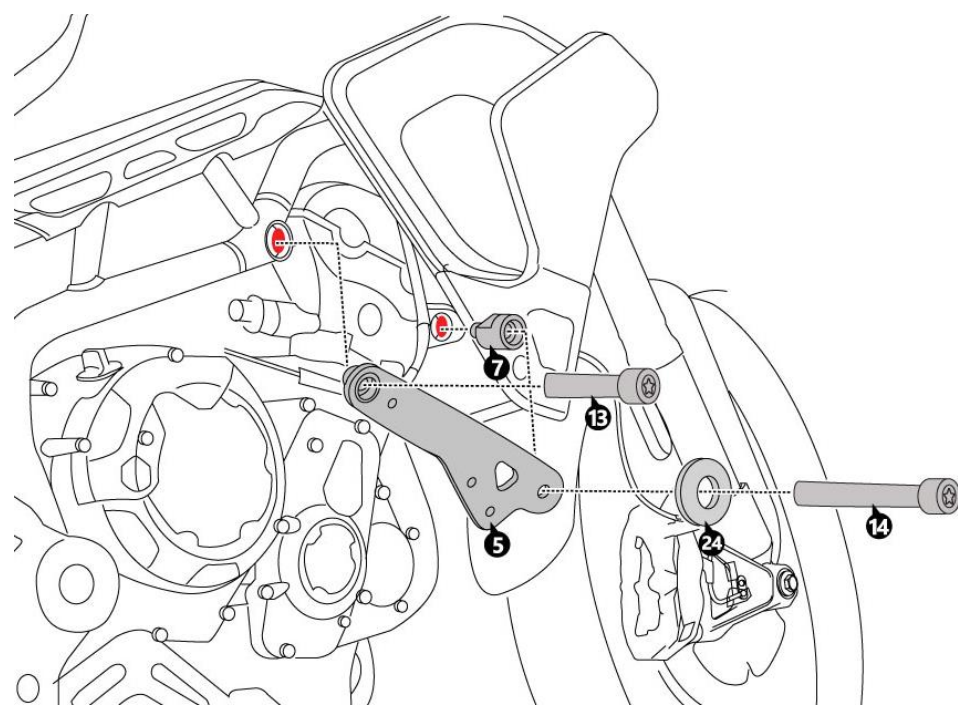

Step 5:

Orient the Crash Bar Top RH (3) And Slide-in Washer M8 (23) – 2 off Screw M8x15 (16) – 2 off and through the Mounting hole in the Crash Bar Top RH (3) to the Bracket RH (5)

Orient the Crash Bar Lower RH (4) And Slide-in Washer M8 (23)-1 off Screw M10x35 (19) – 1 off , Screw M8x15 (16) – 1 off ,and through the Mounting hole in the Crash Bar Lower RH (4) to the Bracket RH (5) as show red color .

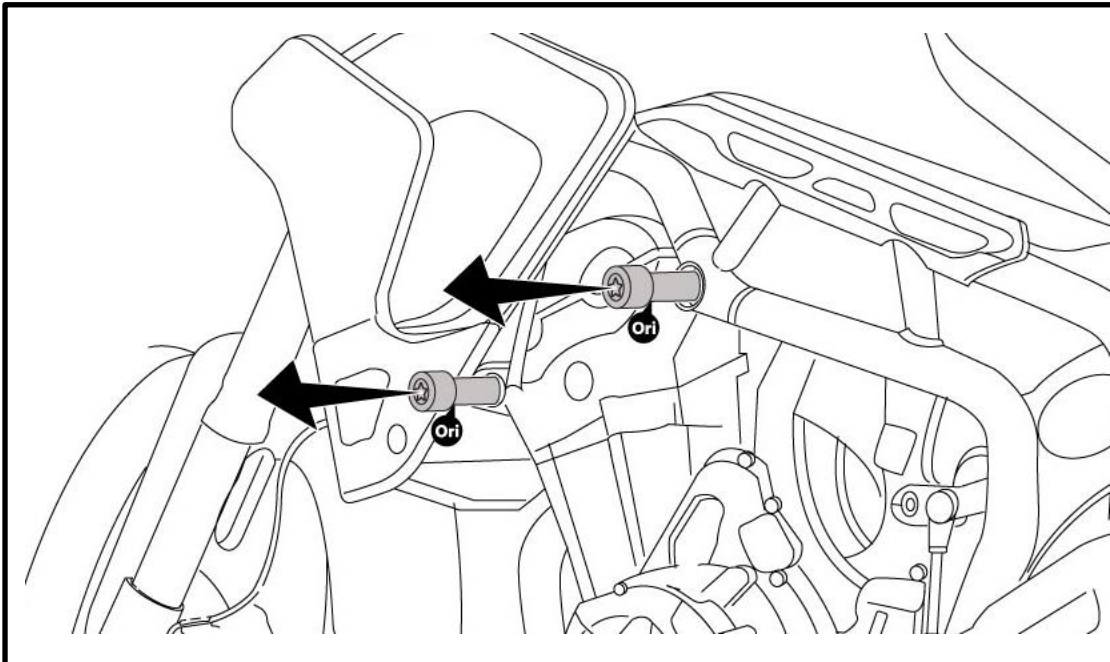

Step 6:

Before starting to mount the Bracket we have to unscrew the Mounting - 2 Original Screw in Motorbike. (As shown)

Step 7:

Orient the Bracket LH (6) is to be mounted to the Motorbike Chassis Frame as shown.

Slide-in the Bush (8) -1 off, Washer (24) -1 off, Screw M10 x 135 (15) -1 off, Screw M10x60 (13) and through the Mounting hole in the Bracket LH (6) and secure the threads in the Motorbike. (As shown)

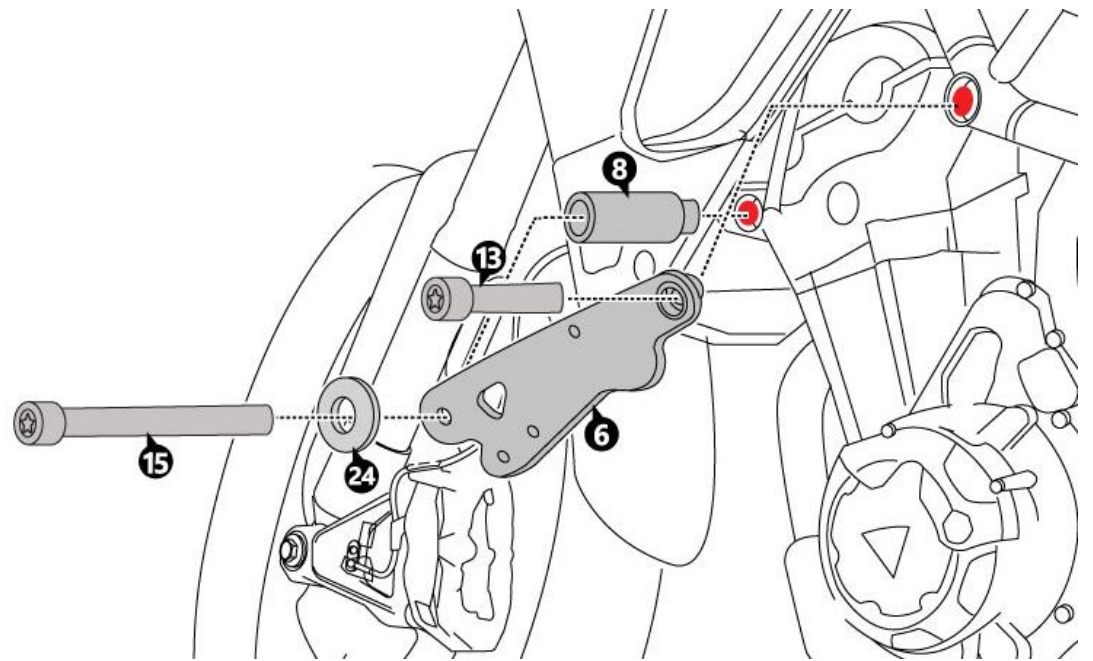

Step 8:

Orient the Crash Bar Top LH (2) And Slide-in Washer M8 (23) – 2 off Screw M8x15 (16) – 2 off and through the Mounting hole in the Crash Bar Top RH (3) to the Bracket RH (5)

Orient the Crash Bar Lower LH (1) And Slide-in Screw M8x15 (19) – 1 off , washer M8 (23) 1off, Screw M8x25 (17) – 1 off and through the Mounting hole in the Crash Bar Lower RH (1) to the Bracket LH (6) as show red color .

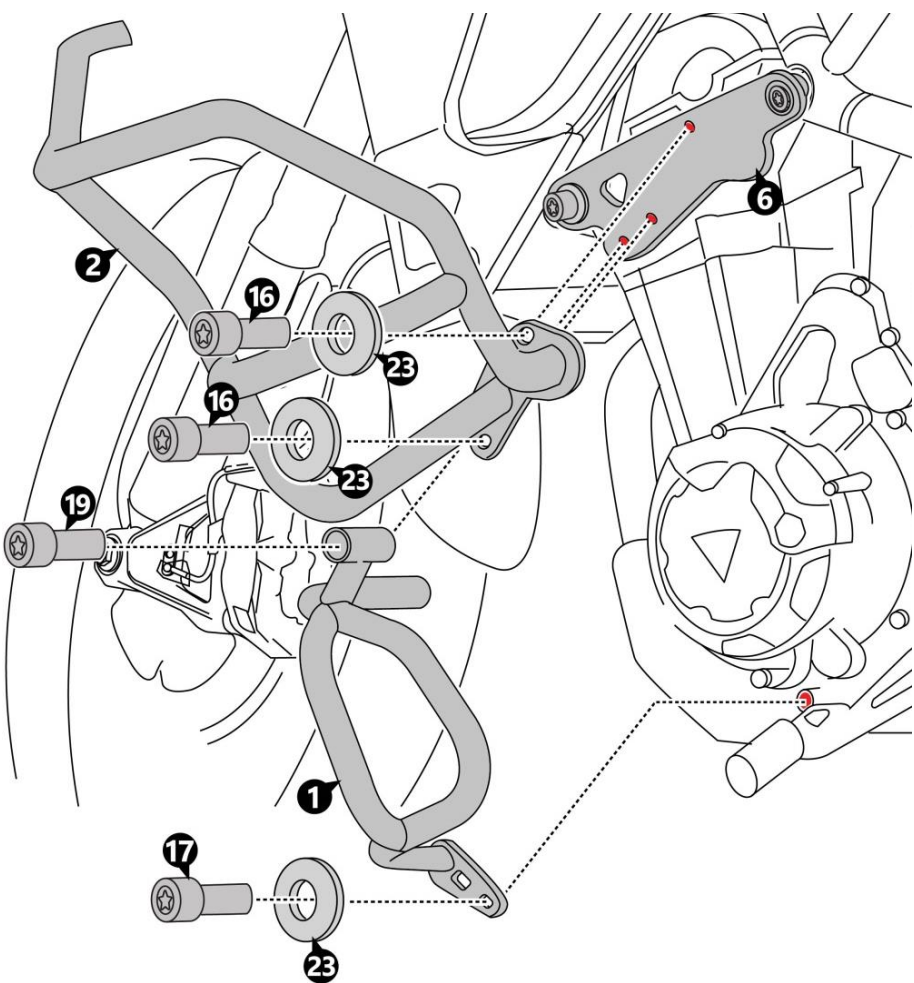

Step 9:

Orient the Top End of the Crash Bar RH (3) & LH (2) to the Pin pipe Upper (10) attached to the Top Bracket (9).

And Slide-in Screw M6x15 (20) – 4 off, and Washer M6 (22) –4 off, through the Mounting hole in the Crash Bar.

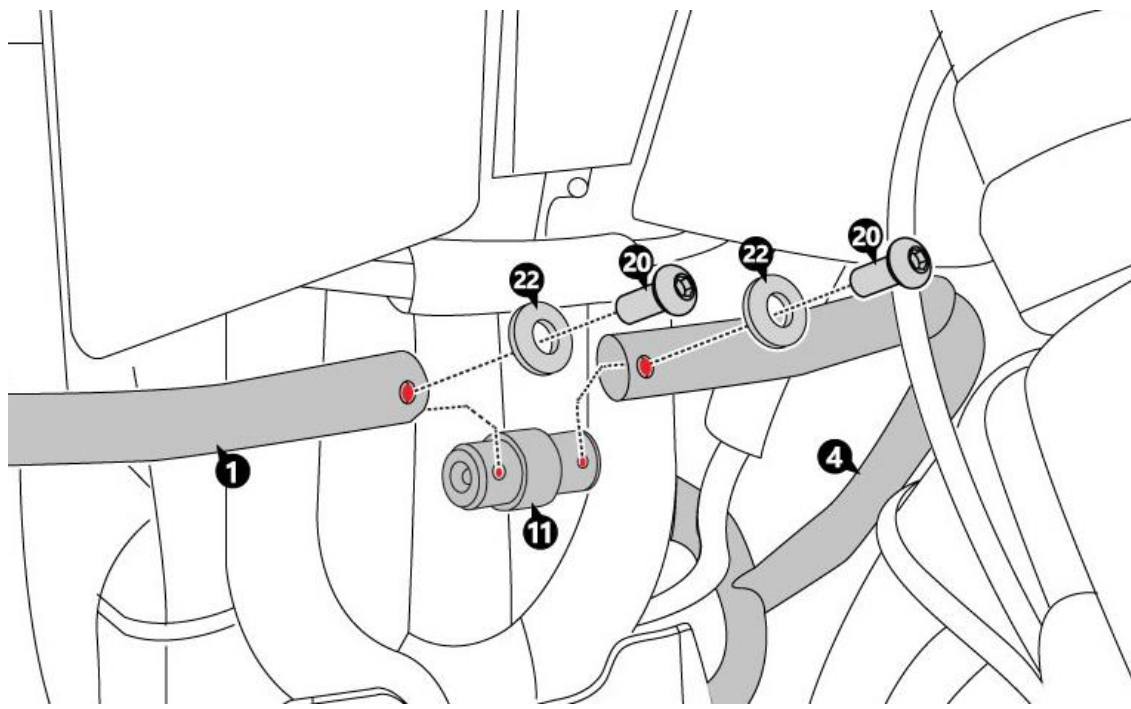
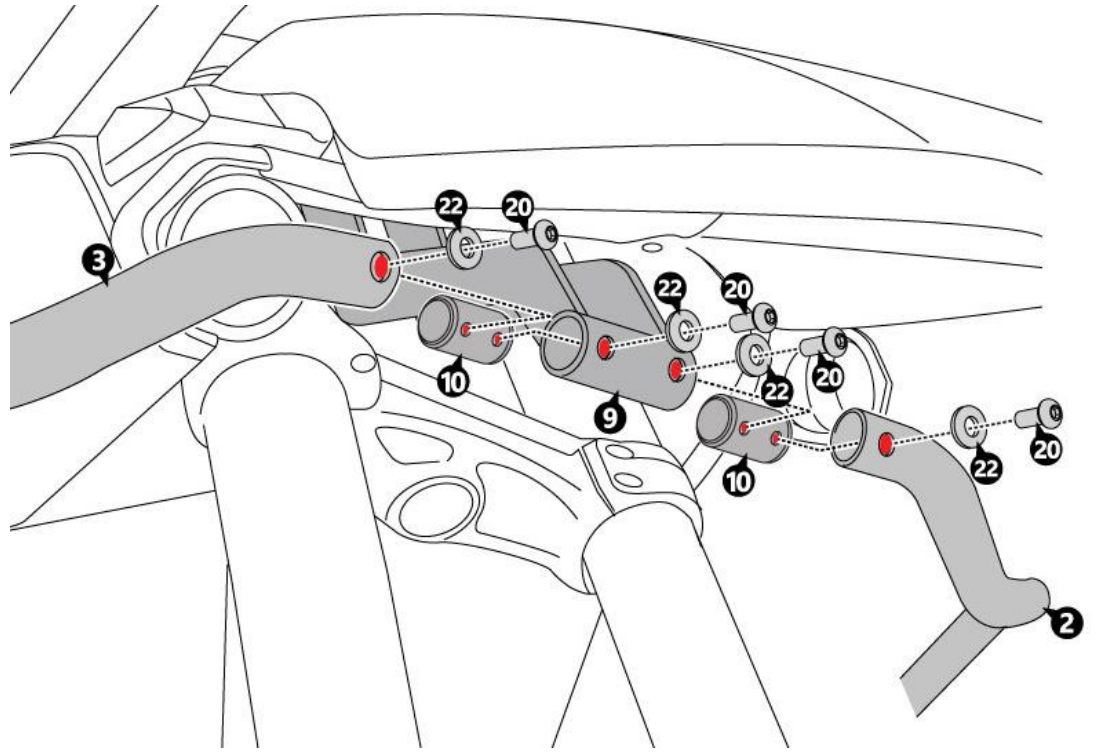

Step 10:

Align the Lower Crash Bar LH&RH, as shown, and slide-in Washer M6 (22) – 2 off Screw M6 x 15 (20) – 2 off and secure the threads in the other end of the Pin pipe (11).

Step 11:

Assemble the Slider Bar on each of the Crash Bar as shown. Use the Slider Bar as the Virtual Orientation and looking from the front side of the Motorbike, make one final Positioning and Alignment of the Crash bars. Ensure mounting symmetry of the Slider Bars visually (it must not be offset or shifted visually when seen from the front side and back side). All Mounting fasteners can be tightened to the torque, as specified in the BOM table.

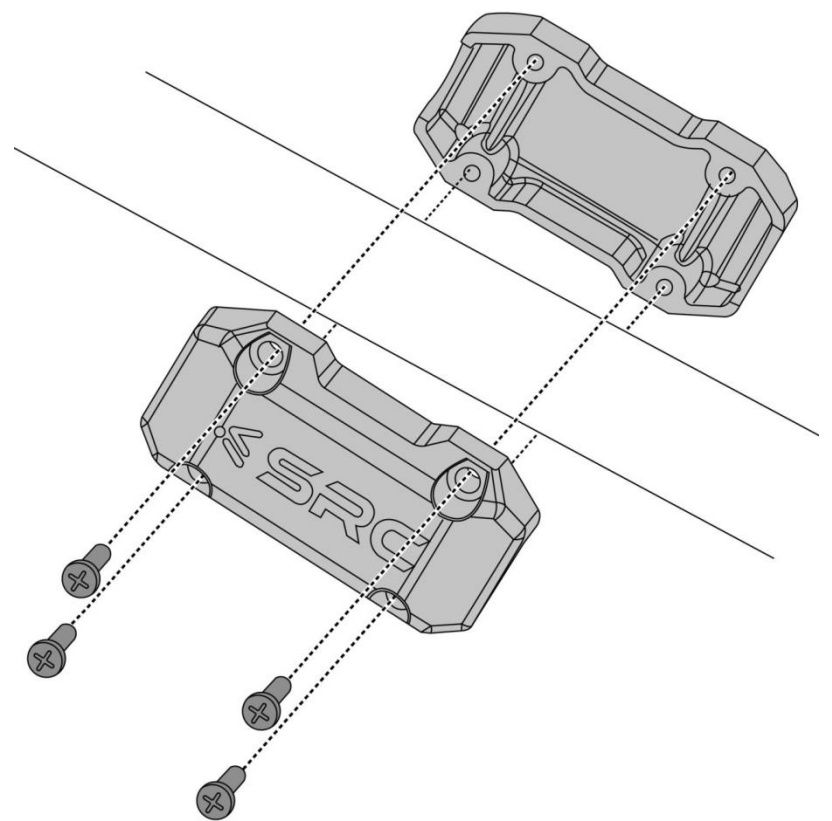

General Information

1. We request you to pay attention to the Mounting Instructions in this document and follow the step-by-step procedures.
2. This Mounting Instruction manual is a “Do It Yourself” (DIY) fitment manual of the Accessory part to the Vehicle. We have prepared this based on our experience and knowledge, related to the Vehicle, Part and its functional aspects.
3. SRC cannot guarantee the interchangeability of the parts to any other manufacturer’s accessory part. It is advised to the User, to inspect and ensure the original state of all other Vehicle parts.
4. We request you to bear in mind, that the Installed part can change the driving behaviour and/or the stability during driving or any other dynamic conditions.
5. If you have the appropriate tools and another person to assist you in the mounting, it will help.
6. To the maximum extent possible, our design use the current Mounting/Fitment of the Original Equipment, so that Installation of these accessories will not affect the Payload or Function of the Vehicle or the Part on which it is mounted to protect it
7. If any additional modifications are to be done, prior to the fitment of the accessories, it will be explicitly specified in the instruction sheets.